

NEX10/M-4.3-10/F RF ADAPTER

Specifications of low PIM NEX10 Male to 4.3/10 Female RF Adapter

Mechanical & Electrical Specification:

Model	NEX10/M-4.3/F
Frequency Range	0~6GHz
VSWR	≤1.15(0~6GHz)
PIM (2X43dBm)	<-160dBc (<-165dBc Typical)
Plating	Silvering & Ternary Alloy
Insulator	PTFE
Connector	NEX10 Male to 4.3/10 Female
Impedance	50Ω
Durability	500 Cycles

When results tested by different analyzers are different should adopt the HP testing device as criteria.

Material & Plating:

Name of part	Material	Plating	Thickness of Plating
Shell	Brass (HPb59-1)	Ternary Alloy or Silver Plated	2~3μ
Out conductor	Brass (HPb59-1)	Ternary Alloy or Silver Plated	2~3μ
Connecting nut	Brass (HPb59-1)	Ternary Alloy or Nickel Plated	2~3μ
Sealing	Silicone rubber		
Probe	Brass (HPb59-1)	Silver Plated	2~3μ
Insulator	PTFE (SFX-1)		

Dimensions:

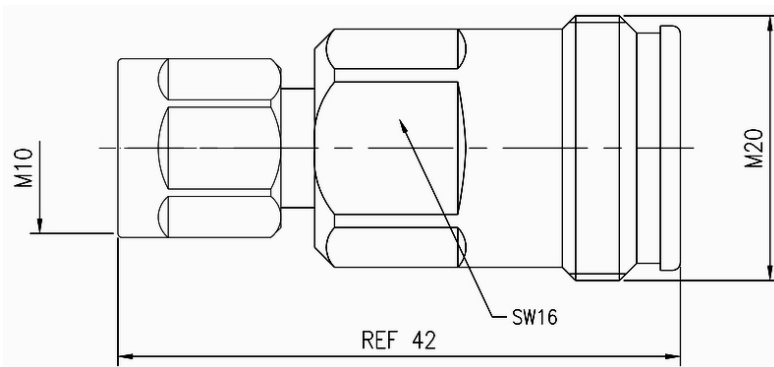

Note: The drawing only for reference, please make the object as the standard.



NEX10/M-N/M RF ADAPTER



Tone Spread
Solutions for Wireless Signal

Communications Technology & Engineering Accessories

Rev.V1.0

Specifications of low PIM NEX10 Male to N Male RF Adapter

Mechanical & Electrical Specification:

Model	NEX10/M-N/M
Frequency Range	0~6GHz
VSWR	≤1.15(0~6GHz)
PIM (2X43dBm)	<-153dBc (<-165dBc Typical)
Plating	Silvering & Ternary Alloy
Insulator	PTFE
Connector	NEX10 Male to N Male
Impedance	50Ω
Durability	500 Cycles

When results tested by different analyzers are different should adopt the HP testing device as criteria.

Material & Plating:

Name of part	Material	Plating	Thickness of Plating
Shell	Brass (HPb59-1)	Ternary Alloy or Silver Plated	2~3μ
Out conductor	Brass (HPb59-1)	Ternary Alloy or Silver Plated	2~3μ
Connecting nut	Brass (HPb59-1)	Ternary Alloy or Nickel Plated	2~3μ
Sealing	Silicone rubber		
Probe	Brass (HPb59-1)	Silver Plated	2~3μ
Insulator	PTFE (SFX-1)		

Dimensions:

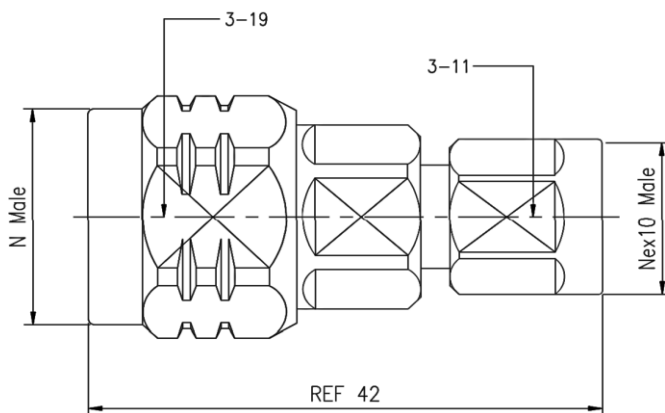

Note: The drawing only for reference, please make the object as the standard.



All specifications are subject to change without notice. ©2019 TONE SPREAD TECHNOLOGY CO., LTD. All Rights Reserved. Website <http://www.tspd.com.tw>

ADD:11169 2F,No 141,Fu-Gang St. Taipei ,Taiwan TEL:+886-2-28828979 FAX:+886-2-28829196 E-mail: sales@tspd.com.tw

NEX10/F-N/M RF ADAPTER



Tone Spread
Solutions for Wireless Signal

Communications Technology & Engineering Accessories

Rev.V1.0

Specifications of NEX10/Female to N/Male RF Adapter

Mechanical & Electrical Specification:

Model	NEX10/F-N/M
Frequency Range	0~6GHz
VSWR	≤1.15(0~6GHz)
PIM (2X43dBm)	<-153dBc (<-165dBc Typical)
Plating	Silvering & Ternary Alloy
Insulator	PTFE
Connector	NEX10 Female to N Male
Impedance	50Ω
Durability	500 Cycles

When results tested by different analyzers are different should adopt the HP testing device as criteria.

Material & Plating:

Name of part	Material	Plating	Thickness of Plating
Shell	Brass (HPb59-1)	Ternary Alloy or Silver Plated	2~3μ
Out conductor	Brass (HPb59-1)	Ternary Alloy or Silver Plated	2~3μ
Connecting nut	Brass (HPb59-1)	Ternary Alloy or Nickel Plated	2~3μ
Sealing	Silicone rubber		
Probe	Brass (HPb59-1)	Silver Plated	2~3μ
Insulator	PTFE (SFX-1)		

Dimensions:

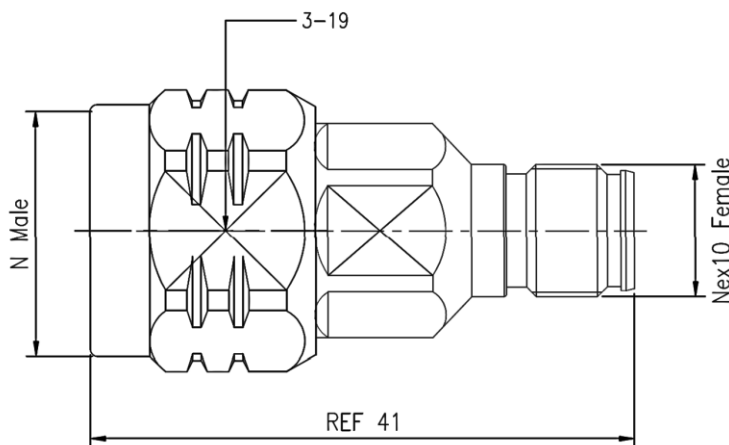

Note: The drawing only for reference, please make the object as the standard.



All specifications are subject to change without notice. ©2019 TONE SPREAD TECHNOLOGY CO., LTD. All Rights Reserved. Website <http://www.tspd.com.tw>

ADD:11169 2F,No 141,Fu-Gang St. Taipei ,Taiwan TEL:+886-2-28828979 FAX:+886-2-28829196 E-mail: sales@tspd.com.tw

NEX10/F-N/F RF ADAPTER

Specifications of NEX10/Female to N/Female Bulkhead RF Adapter

Mechanical & Electrical Specification:

Model	NEX10/F-N/F
Frequency Range	0~6GHz
VSWR	≤1.15(0~6GHz)
PIM (2X43dBm)	<-153dBc (<-165dBc Typical)
Plating	Silvering & Ternary Alloy
Insulator	PTFE
Connector	NEX10 Female to N Female
Impedance	50Ω
Durability	500 Cycles

When results tested by different analyzers are different should adopt the HP testing device as criteria.

Material & Plating:

Name of part	Material	Plating	Thickness of Plating
Shell	Brass (HPb59-1)	Ternary Alloy or Silver Plated	2~3μ
Out conductor	Brass (HPb59-1)	Ternary Alloy or Silver Plated	2~3μ
Connecting nut	Brass (HPb59-1)	Ternary Alloy or Nickel Plated	2~3μ
Sealing	Silicone rubber		
Probe	Brass (HPb59-1)	Silver Plated	2~3μ
Insulator	PTFE (SFX-1)		

Dimensions:

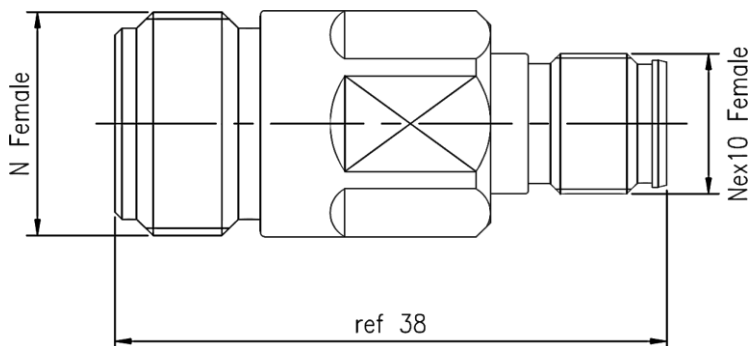

Note: The drawing only for reference, please make the object as the standard.



NEX10/F-4.3-10/F RF ADAPTER



Tone Spread
Solutions for Wireless Signal

Communications Technology & Engineering Accessories

Rev.V1.0

Specifications of NEX10/Female to 4.3/10 Female Bulkhead RF Adapter

Mechanical & Electrical Specification:

Model	NEX10/F-N/F
Frequency Range	0~6GHz
VSWR	≤1.15(0~6GHz)
PIM (2X43dBm)	<-153dBc (<-165dBc Typical)
Plating	Silvering & Ternary Alloy
Insulator	PTFE
Connector	NEX10 Female to 4.3/10 Female
Impedance	50Ω
Durability	500 Cycles

When results tested by different analyzers are different should adopt the HP testing device as criteria.

Material & Plating:

Name of part	Material	Plating	Thickness of Plating
Shell	Brass (HPb59-1)	Ternary Alloy or Silver Plated	2~3μ
Out conductor	Brass (HPb59-1)	Ternary Alloy or Silver Plated	2~3μ
Connecting nut	Brass (HPb59-1)	Ternary Alloy or Nickel Plated	2~3μ
Sealing	Silicone rubber		
Probe	Brass (HPb59-1)	Silver Plated	2~3μ
Insulator	PTFE (SFX-1)		

Dimensions:

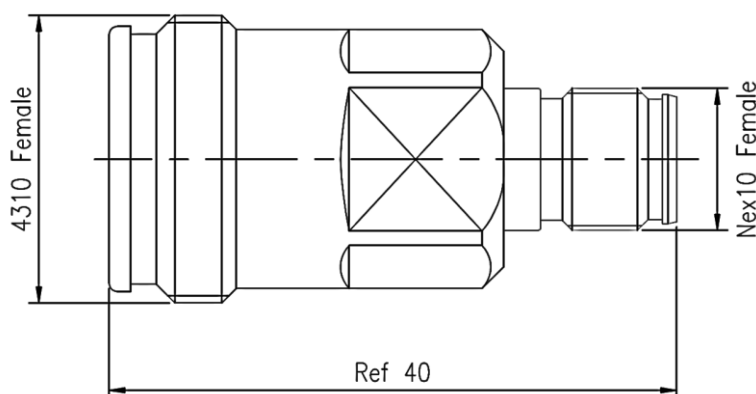

Note: The drawing only for reference, please make the object as the standard.



All specifications are subject to change without notice. ©2019 TONE SPREAD TECHNOLOGY CO., LTD. All Rights Reserved. Website <http://www.tspd.com.tw>

ADD:11169 2F,No 141,Fu-Gang St. Taipei ,Taiwan TEL:+886-2-28828979 FAX:+886-2-28829196 E-mail: sales@tspd.com.tw

NEX10/F-NEX10/F RF ADAPTER



Tone Spread
Solutions for Wireless Signal

Communications Technology & Engineering Accessories

Rev.V1.0

Specifications of low PIM NEX10 Female to NEX10 Female RF Adapter

Mechanical & Electrical Specification:

Model	NEX10/F-NEX10/F
Frequency Range	0~6GHz
VSWR	≤1.15(0~6GHz)
PIM (2X43dBm)	<-153dBc (<-165dBc Typical)
Plating	Silvering & Ternary Alloy
Insulator	PTFE
Connector	NEX10 Female to NEX10 Female
Impedance	50Ω
Durability	500 Cycles

When results tested by different analyzers are different should adopt the HP testing device as criteria.

Material & Plating:

Name of part	Material	Plating	Thickness of Plating
Shell	Brass (HPb59-1)	Ternary Alloy or Silver Plated	2~3μ
Out conductor	Brass (HPb59-1)	Ternary Alloy or Silver Plated	2~3μ
Connecting nut	Brass (HPb59-1)	Ternary Alloy or Nickel Plated	2~3μ
Sealing	Silicone rubber		
Probe	Brass (HPb59-1)	Silver Plated	2~3μ
Insulator	PTFE (SFX-1)		

Dimensions:

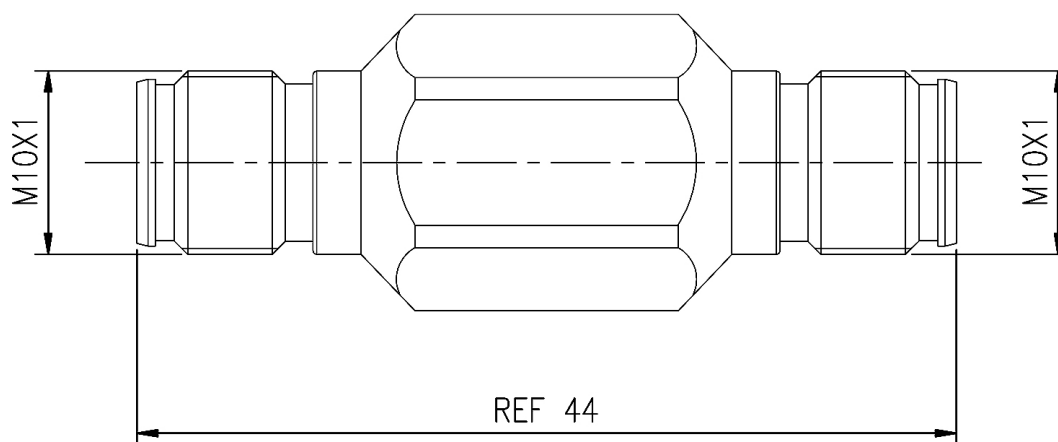

Note: The drawing only for reference, please make the object as the standard.



All specifications are subject to change without notice. ©2019 TONE SPREAD TECHNOLOGY CO., LTD. All Rights Reserved. Website <http://www.tspd.com.tw>

ADD:11169 2F,No 141,Fu-Gang St. Taipei ,Taiwan TEL:+886-2-28828979 FAX:+886-2-28829196 E-mail: sales@tspd.com.tw

NEX10/F-NEX/F(BH) RF ADAPTER



Tone Spread
Solutions for Wireless Signal

Communications Technology & Engineering Accessories

Rev.V1.0

Specifications of NEX10/Female to NEX10/Female Bulkhead RF Adapter

Mechanical & Electrical Specification:

Model	NEX10/F-NEX10/F(BH)
Frequency Range	0~6GHz
VSWR	≤1.15(0~6GHz)
PIM (2X43dBm)	<-153dBc (<-165dBc Typical)
Plating	Silvering & Ternary Alloy
Insulator	PTFE
Connector	NEX10 Female to NEX10 Female
Impedance	50Ω
Durability	500 Cycles

When results tested by different analyzers are different should adopt the HP testing device as criteria.

Material & Plating:

Name of part	Material	Plating	Thickness of Plating
Shell	Brass (HPb59-1)	Ternary Alloy or Silver Plated	2~3μ
Out conductor	Brass (HPb59-1)	Ternary Alloy or Silver Plated	2~3μ
Connecting nut	Brass (HPb59-1)	Ternary Alloy or Nickel Plated	2~3μ
Sealing	Silicone rubber		
Probe	Brass (HPb59-1)	Silver Plated	2~3μ
Insulator	PTFE (SFX-1)		

Dimensions:

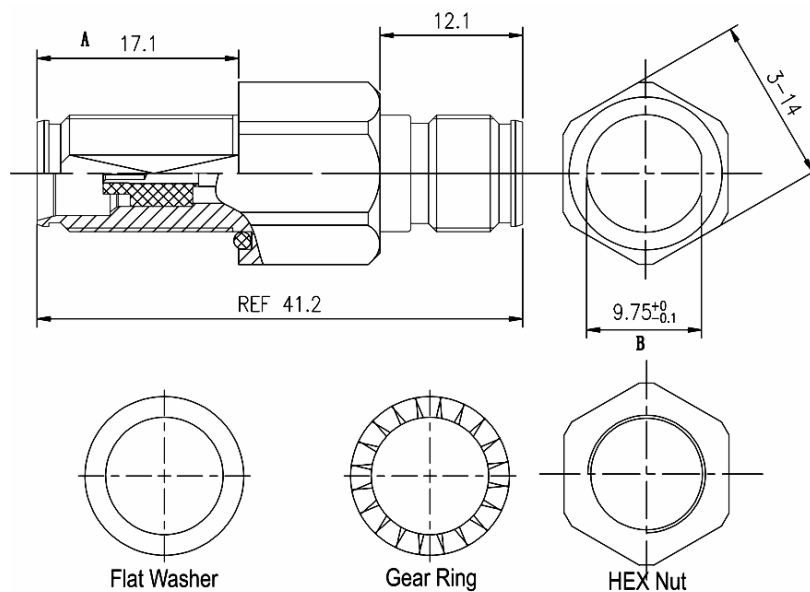

Note: The drawing only for reference, please make the object as the standard.

